

Up Delaware River
 1 N 13 W 7½
 2 N 35 W 14
 3 N 14 W 12
 4 N 24 W 2¾
 36¼

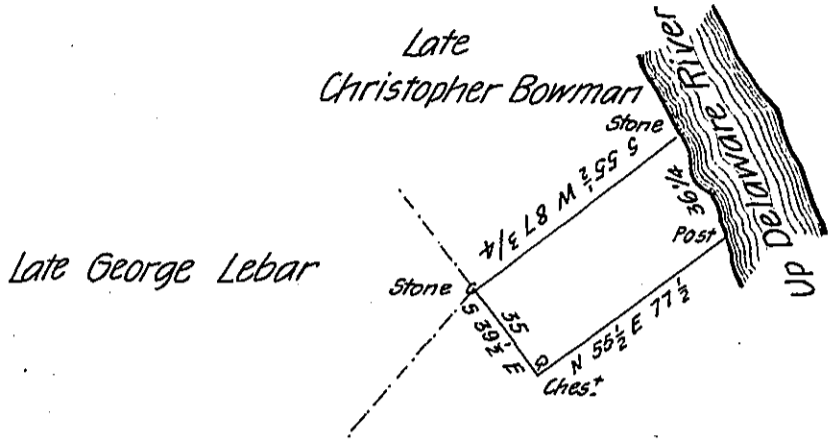

Late Christopher Bowman

Late George Lebar

Late Thomas Quick

Now

Simon Hart & Eleazer Brothwell

A Draft of a tract of Land situate in Upper Mount Bethel Town-
 ship Northampton County Containing Sixteen acres one hundred fifty perches
 and the allowance of six P. Cent &c. Being part of 279 or 280 Acres Originally
 Surveyed to Thomas Quick by Warrant dated the 11-May 1753 Surveyed for
 George Labarr the 6-January 1818

P-

Geo. Palmer D.S.

To Rich^d T. Leech Esq^r

Surveyor General

IN TESTIMONY that the above is a copy of the original remaining on file in
 the Department of Internal Affairs of Pennsylvania, made
 conformably to an Act of Assembly approved the 16th day of
 February, 1833, I have hereunto set my Hand and caused
 the Seal of said Department to be affixed at Harrisburg,
 this twenty third day of May 1906

Geo. A. Brown
 Secretary of Internal Affairs.